

This drawing is for illustration purposes only and may differ slightly from the building provided

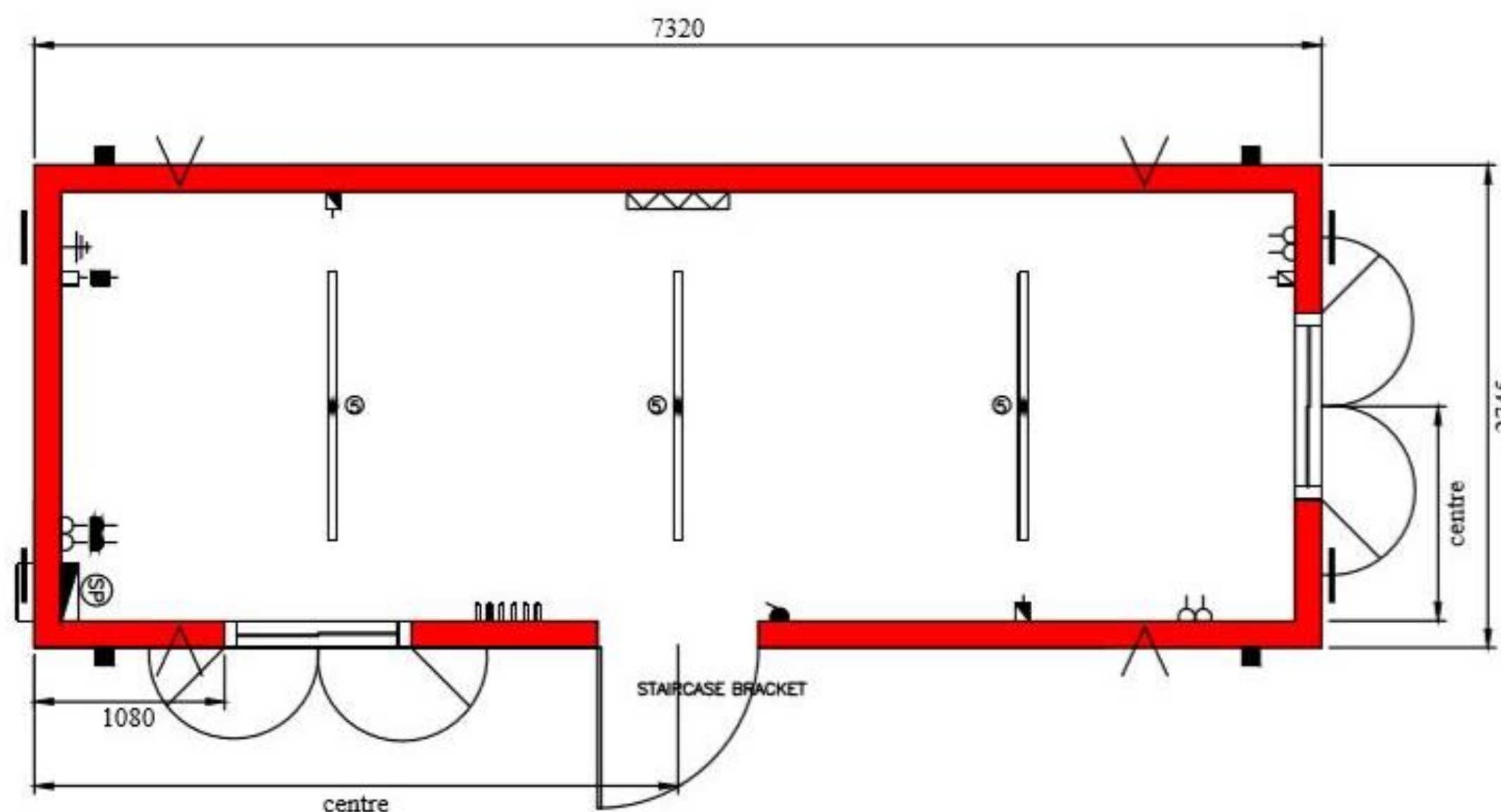
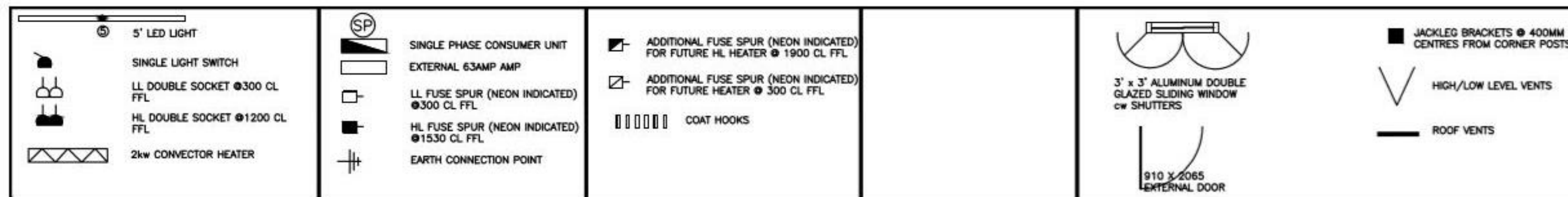

Fittings	Yes	No	General Specifications:		Amendments/Additions to Specifications: +/- 5mm TOLERANCE					
Fork pockets:	X		Wall boards:	SWANSDOWN	FORK POCKETS @ 1800MM CENTRES	EZ ROOF				
Wiring System:			Flooring:	POLYFLOOR- GREY	100 X 50 CHANNEL BASE RAIL					
6242YH to BS 6004			Cabin Profile:	FLAT	76 X 38 CHANNEL ROOF RAIL					
Checked and Signed			Insulation:	50MM KNAUF SLAB			1	10.04.18	FIRST ISSUE	NP
Customer:			Kitchen:				Issue	Date	Amendments	Draw
Sales:			Drawing No:	STACK - 9702	7320mm x 2745mm OFFICE					
Production:			Job No:							

LCS MODULAR BUILDINGS

Drawn By; WLM

Project Name

24ft x 9ft
Open Plan Office

Client;

LCS Containers
Lichfield Road
Brantson
Lichfield
DE14 3HD
01283 204 729
Info@LCSmodularbuildings.co.uk

Date;

Drawing No: LCS